

# WASCO

SWITCHES & SENSORS

## P10 AUTOMATIC RESET SWITCH SERIES

P10 automatic reset switches will change the state of the electrical poles (cut-in/cut-out) when the pressure crosses the set point. The electrical state will return to the previous state when the pressure crosses the reset point. These switches do not need human interaction to operate.



## P10 SERIES FEATURES

The P10 Series incorporates an all-welded unit design eliminating leak paths, and the stainless steel exterior body enables this series for all-weather use. This series is a perfect switch for applications that require monitoring of cleaning agents and gases. Multiple fittings and electrical connections are available for the P10 Series.

## TYPICAL APPLICATIONS

- Fire Suppression Systems
- Factory Automation Systems
- Medical Equipment
- HVAC-R Control
- Gas Generation Systems
- Food Processing
- Pharmaceutical

## P10 SERIES PERFORMANCE CHART

<b>Set Point Range</b>	0 - 1000*
<b>Operating Pressure</b>	0 - 1500*
<b>Proof Pressure</b>	Operating Pressure x 1.5

All measurements = PSIG  
\* Higher ranges available

## MATERIAL SPECS

<b>Fitting</b>	300 Series SS
<b>Diaphragm</b>	SS
<b>Body</b>	SS

## TECHNICAL SPECS

<b>Ingress Protection</b>	IP65
<b>Leak Rate</b>	$\leq 1 \times 10^{-5}$ cc/min
<b>Electrical Rating</b>	50/60 Hz DX 36V 3A AC 240V 3A Custom Currents Available

## PRODUCT DIMENSIONS

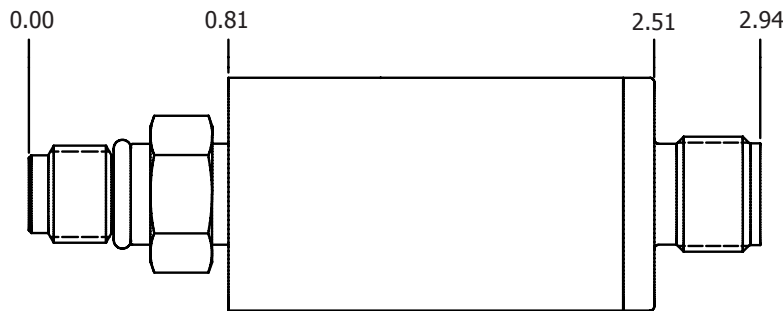

Typical P10 with 1/4" face seal (other configurations available)

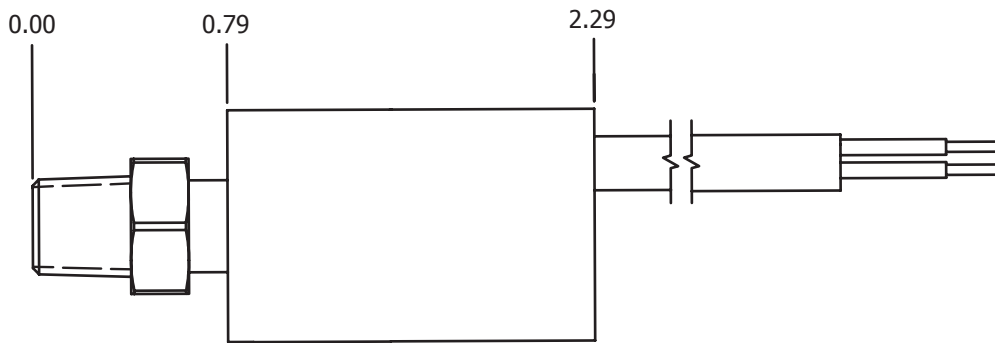

Typical P10 with 1/4" NPT and jacketed wire leads (other configurations available)

We understand how difficult the specifying process is, but we believe it shouldn't be so confusing. Wasco has specified over 6000 unique pressure sensors for thousands of customers since 1963. **Find your solution today by filling out our [worksheet](#).**



\*Information contained in this document is for reference only.  
Actual product specifications will be provided on an engineering drawing.  
Released April, 2024