

# WASCO

SWITCHES & SENSORS

## P6 AUTOMATIC RESET SWITCH SERIES

P6 automatic reset switches will change the state of the electrical poles (cut-in/cut-out) when the pressure crosses the actuation point (setpoint). The electrical state will return to the previous state when the pressure crosses the reset point. These switches do not need human interaction to operate.



## P6 SERIES FEATURES

The P6 automatic reset switch series features an all stainless steel diaphragm and brass fitting or stainless steel fitting. The P6 is UL recognized for operating pressures of  $\leq 800$  PSIG.

## TYPICAL APPLICATIONS

- Fire Suppression Systems
- Factory Automation Systems
- Medical Equipment
- Refrigeration Systems
- HVAC Control
- Gas Generation Systems

## P6 SERIES PERFORMANCE CHART

<b>Set Point Range</b>	0 - 1000*
<b>Operating Pressure</b>	0 - 1200*
<b>Proof Pressure</b>	Operating Pressure x 1.5

All measurements = PSIG  
\* Higher ranges available

## MATERIAL SPECS

<b>Fitting</b>	Brass or 300 Series SS
<b>Diaphragm</b>	SS
<b>Body</b>	Thermoplastic Engineered Polymer (PBT)

## TECHNICAL SPECS

<b>Ingress Protection</b>	IP65
<b>Leak Rate</b>	$\leq 1 \times 10^{-3}$ cc/min
<b>Electrical Rating</b>	DC 36V 6A AC 240V 6A

## PRODUCT DIMENSIONS

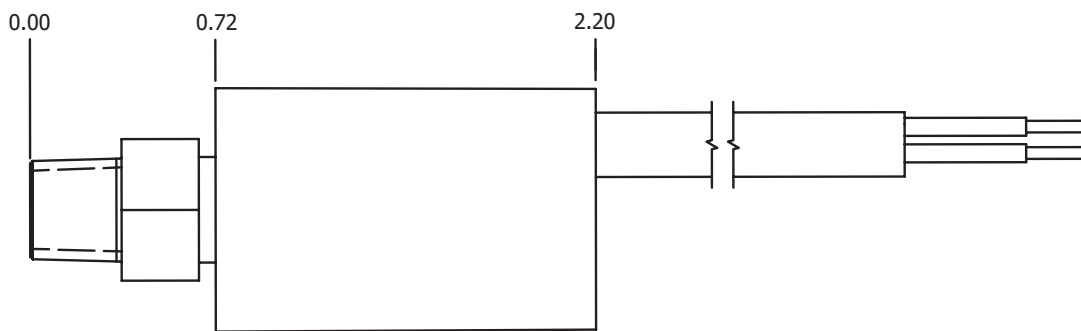

Typical P6 with 1/4" NPT and jacketed wire leads (other configurations available)

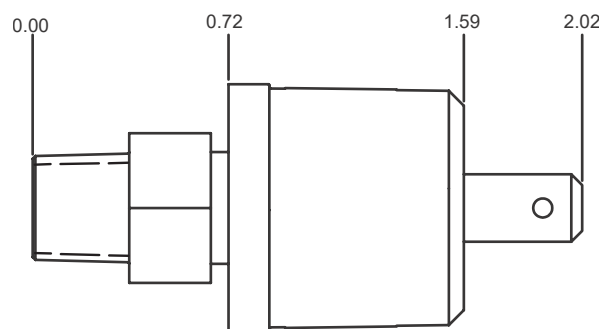

Typical P6 with 1/4" NPT and blade terminals (other configurations available)

We understand how difficult the specifying process is, but we believe it shouldn't be so confusing. Wasco has specified over 6000 unique pressure sensors for thousands of customers since 1963. **Find your solution today by filling out our [worksheet](#).**



SCAN ME